

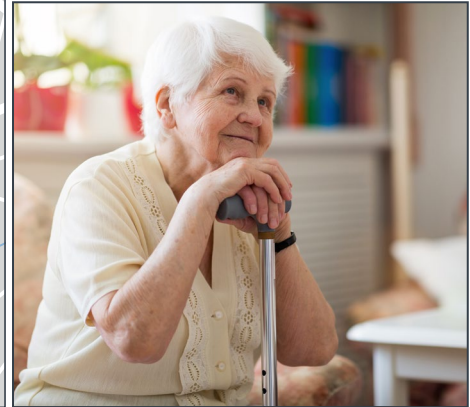

# LESLIE LOADER HOUSE

PEARTREE AVENUE, SOUTHAMPTON, SO19 7RN

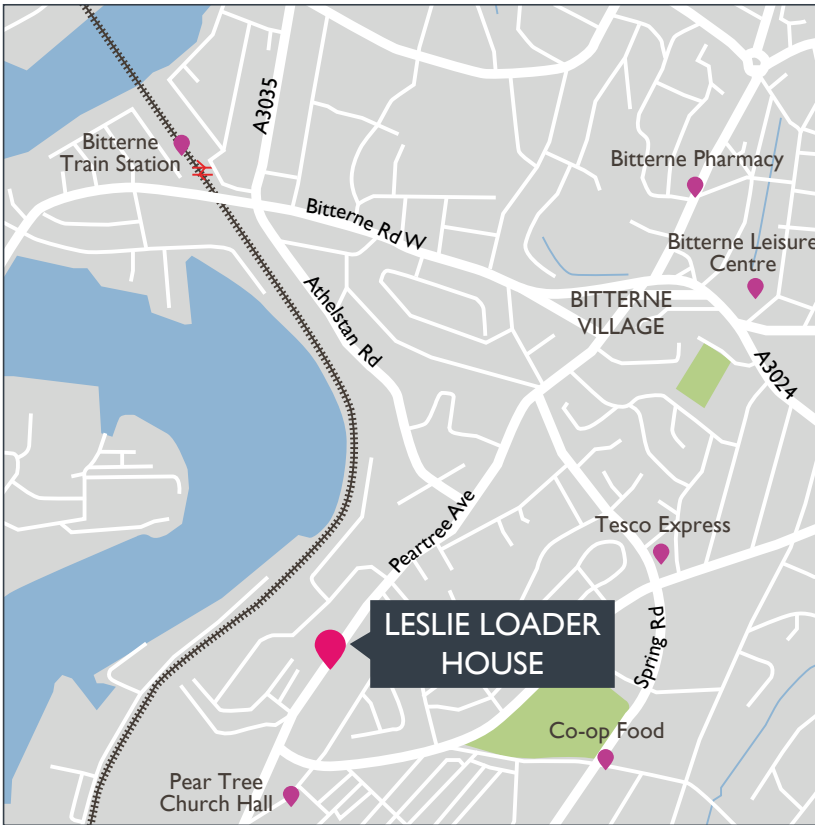





## LOCAL AREA

Leslie Loader House is located in a residential area on the eastern edge of Southampton. Local amenities include a convenience store within a five minute walk, and a bus stop outside the scheme with services into Southampton, via Bitterne, Woolston and West End. The nearest train station is Woolston, with regular services to Portsmouth and Southampton Central.

## ACCOMMODATION

The development consists of 12 studio apartments, 19 one-bedroom apartments and one two-bedroom apartment. Your home will be completely self-contained, with your own front door, and each has their own kitchen and bathroom. Each property also features double glazing and gas central heating.

## ADDITIONAL FACILITIES

-  Door entry system
-  Lift and stairlift
-  Communal lounge
-  Communal kitchen
-  Two guestrooms (available at a small charge)
-  Communal garden
-  Off-street parking





## LIVING AT LESLIE LOADER HOUSE

You get independence and privacy when you want it, with the added advantage of living in a welcoming community environment. There are often opportunities to socialise, with regular coffee mornings and various other social events. However, you choose the lifestyle you want and can be as private or as active as you wish.



## PETS

We understand that pets can be a big part of our lives, however, you must have prior consent before keeping a pet in your home. If you would like to keep a pet, please speak to your scheme manager. They will consider requests based on individual circumstances.

## COSTS

Rent is calculated according to the size and type of property that you live in. There will be service and support charges in addition to this.

For more information about our schemes, or living in retirement housing, please call us on 01403 226000 or email [hello@saxonweald.com](mailto:hello@saxonweald.com). You can also visit our website at [www.saxonweald.com](http://www.saxonweald.com).





SAXON  
WEALD

Saxon Weald  
Saxon Weald House, 38-42 Worthing Road,  
Horsham, West Sussex, RH12 1DT

TEL: 01403 226000 | EMAIL: [hello@saxonweald.com](mailto:hello@saxonweald.com) | WEB: [www.saxonweald.com](http://www.saxonweald.com)

